

# Hidden Winch Plate Mounting instructions for D-Max 2012-18

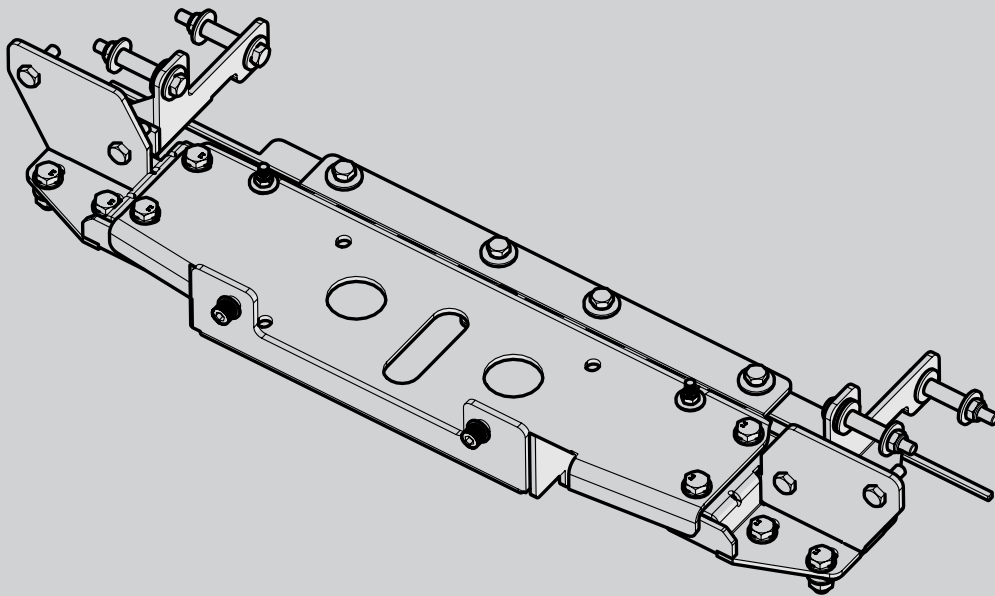

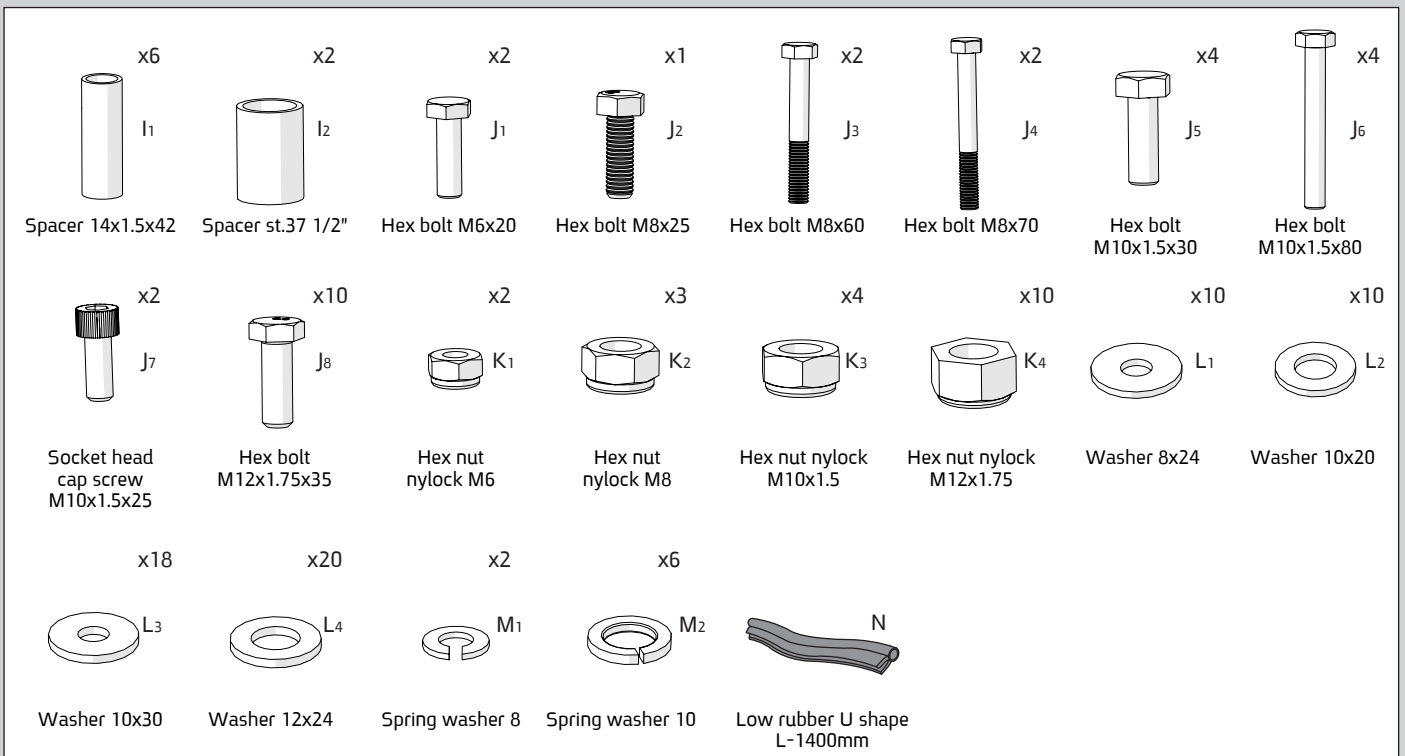

Maximum Tightening Torques	
M6 (8.8)	10 Nm
M8 (8.8)	25 Nm
M10 (8.8)	50 Nm
M12(8.8)	85 Nm

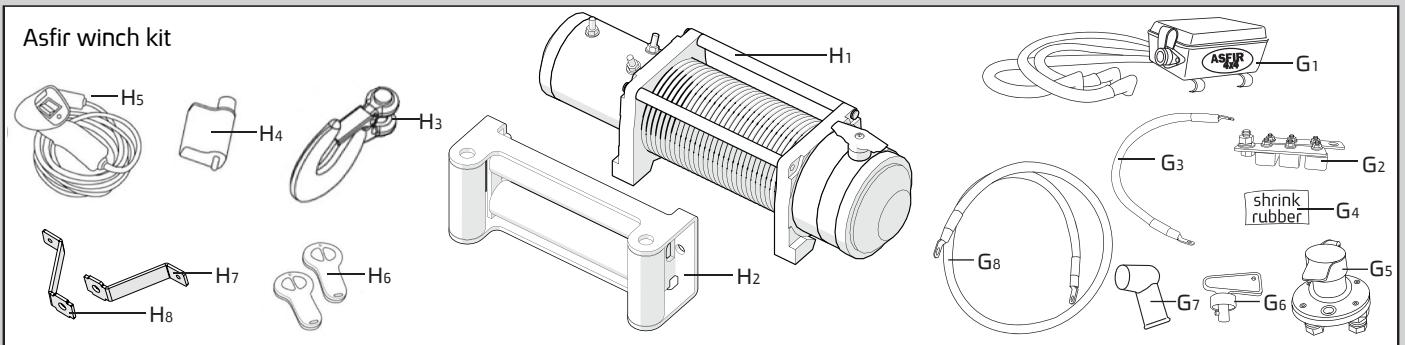
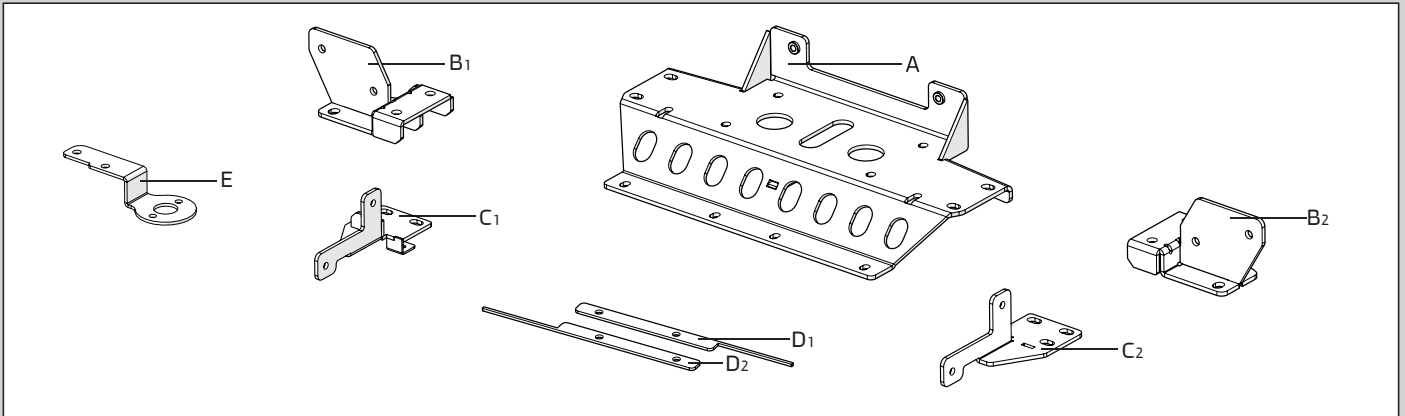
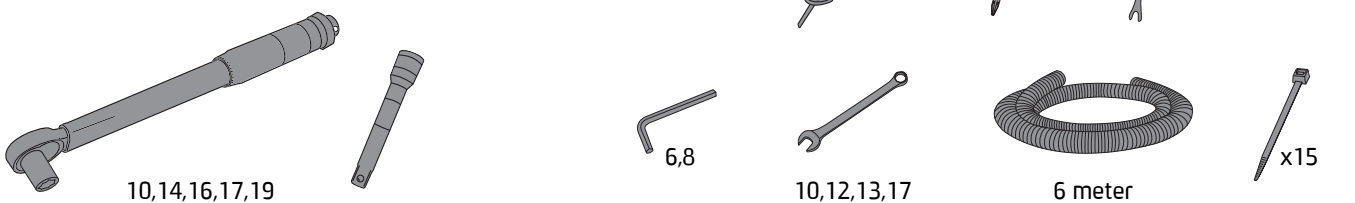

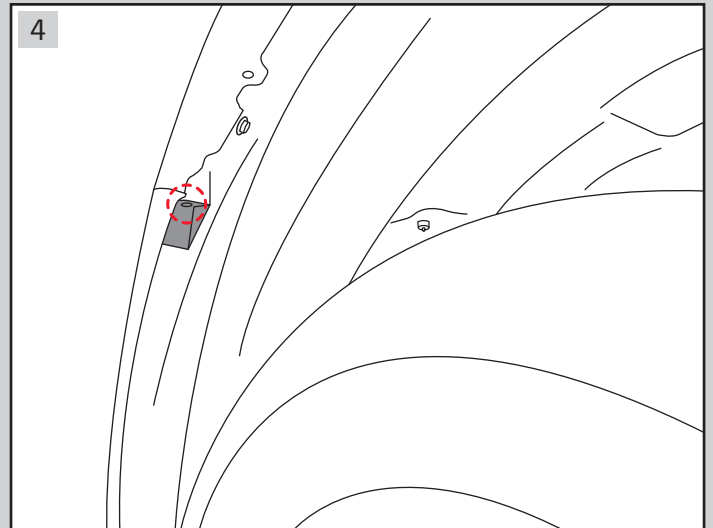
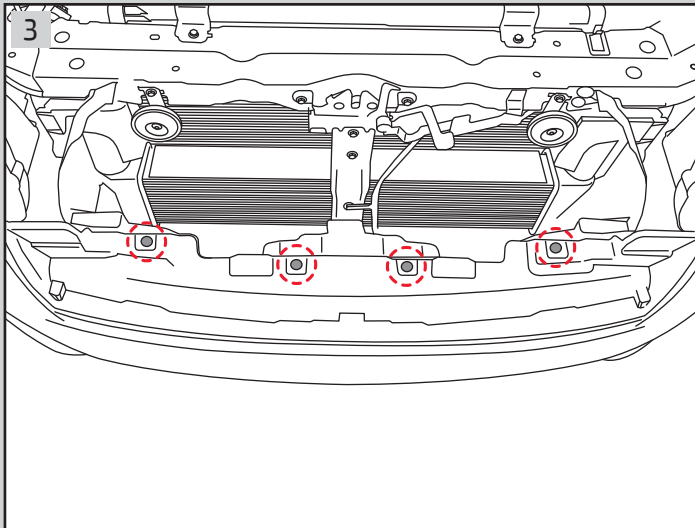
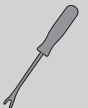
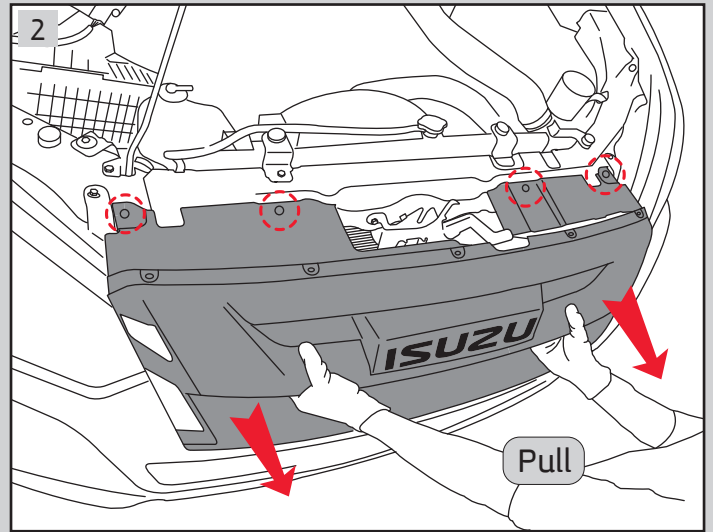
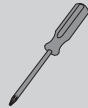
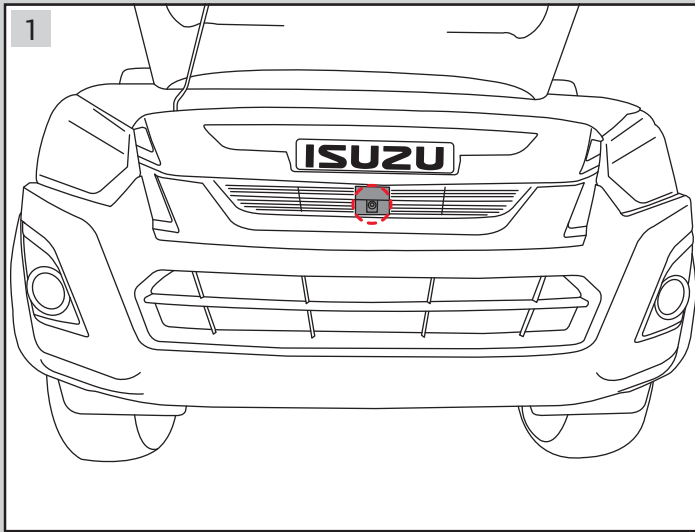

On both sides of the bumper

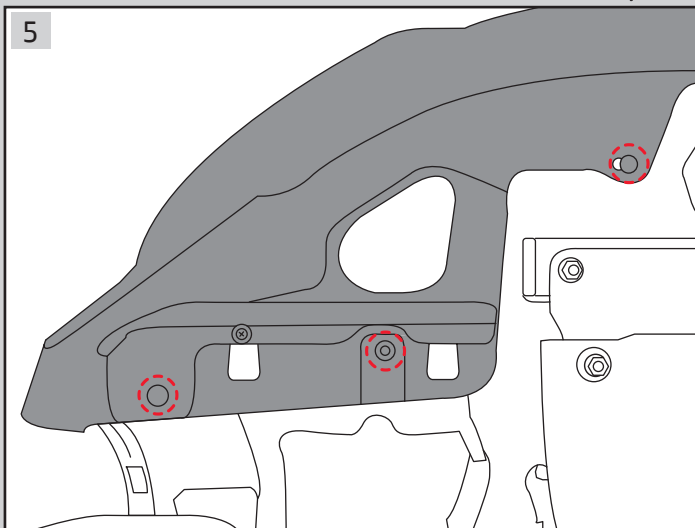
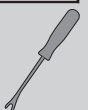

On both sides of the bumper

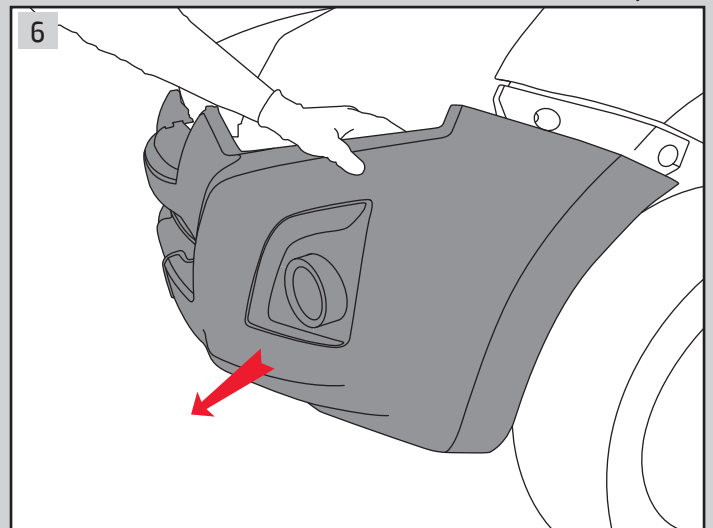
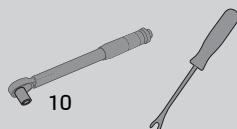

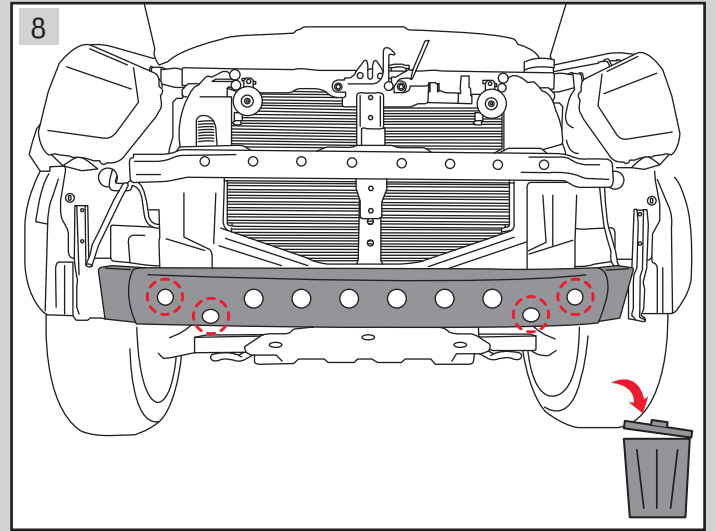
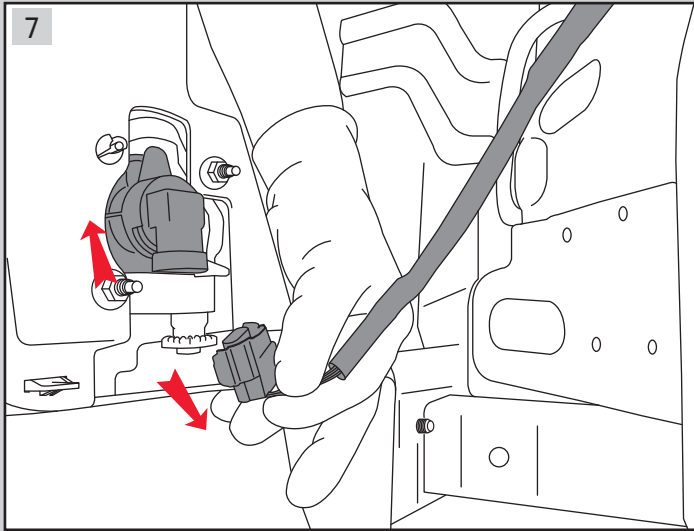

Keep original bolts

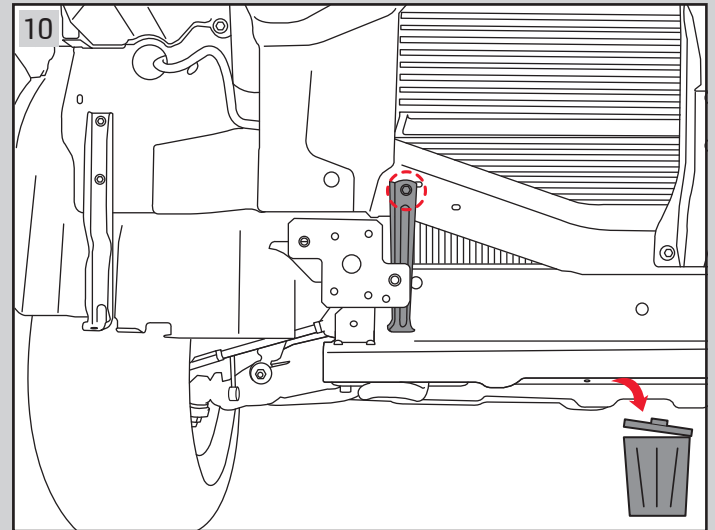
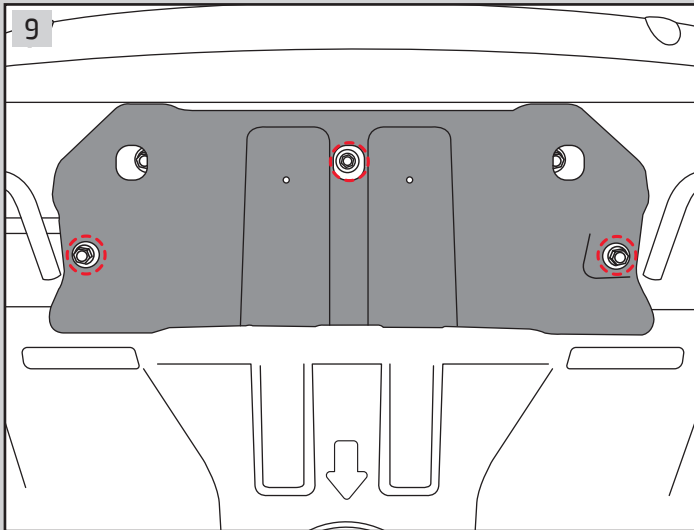
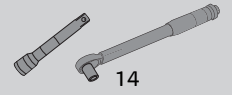

On both sides of the vehicle

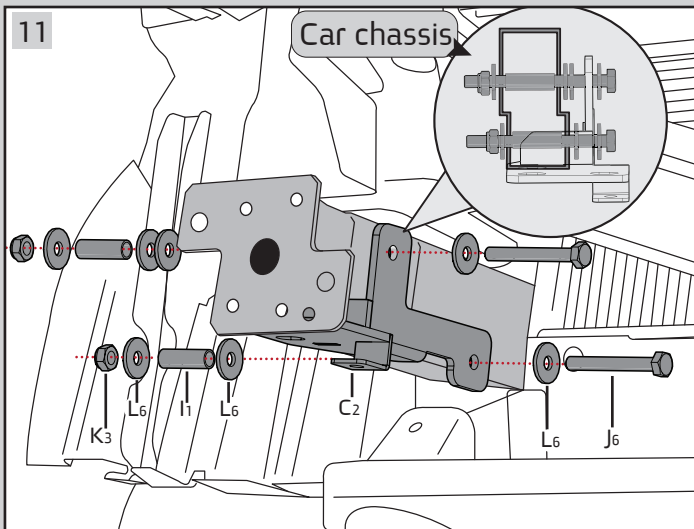
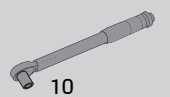

Connect bracket C<sub>1</sub> as shown above to the car chassis on the left side of the vehicle

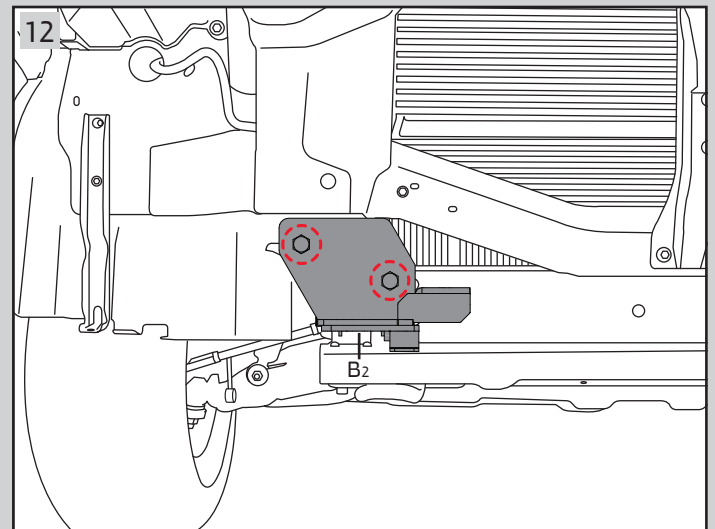
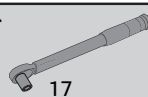

Use original bolts to connect the brackets. Connect bracket B<sub>1</sub> to the left side of the vehicle with original bolts

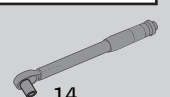



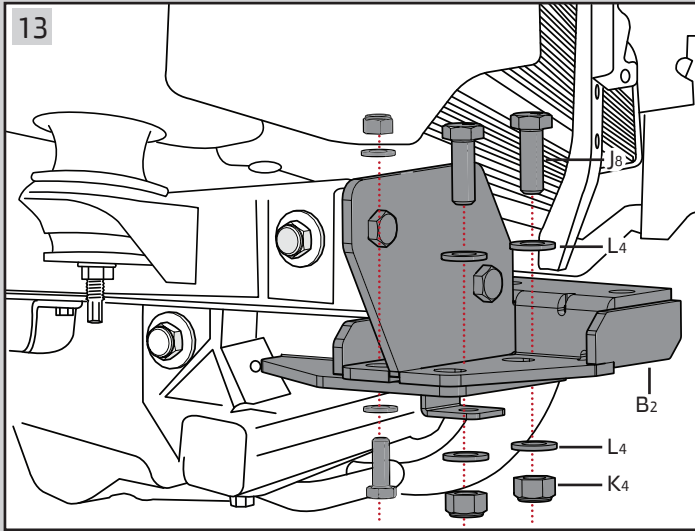

Connect bracket B1 as shown above to car chassis on the left side of the vehicle

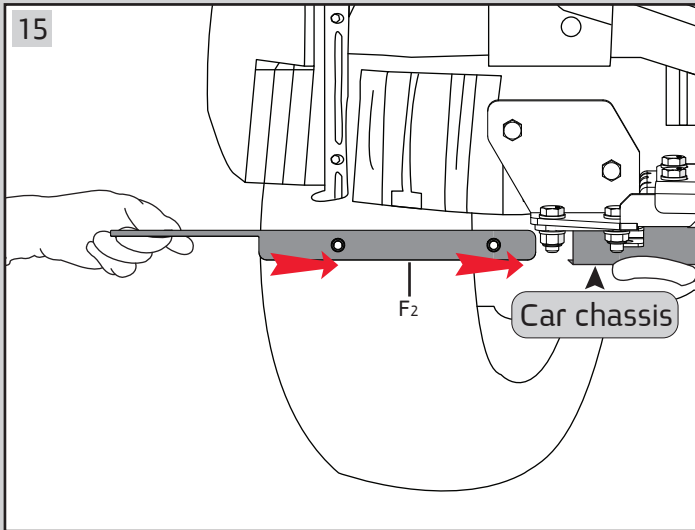
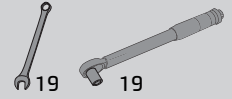
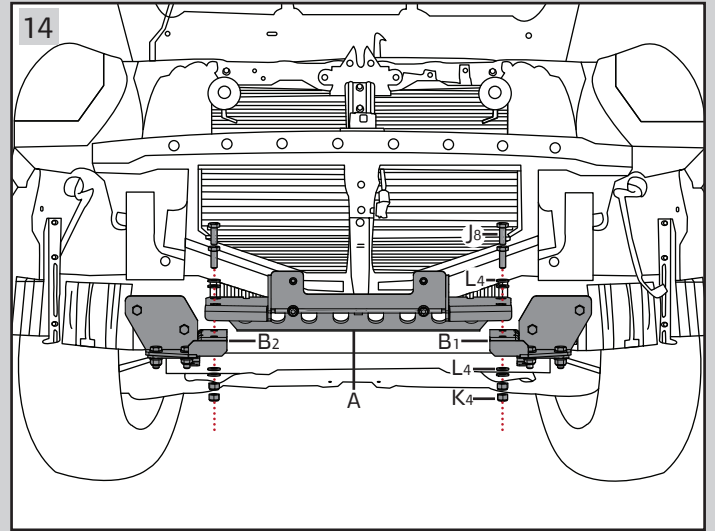
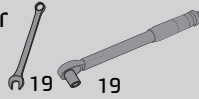

Align palte F2 holes to plate A holes.  
Insert palte F1 on the other side of the car chassis and align the holes

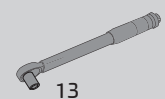
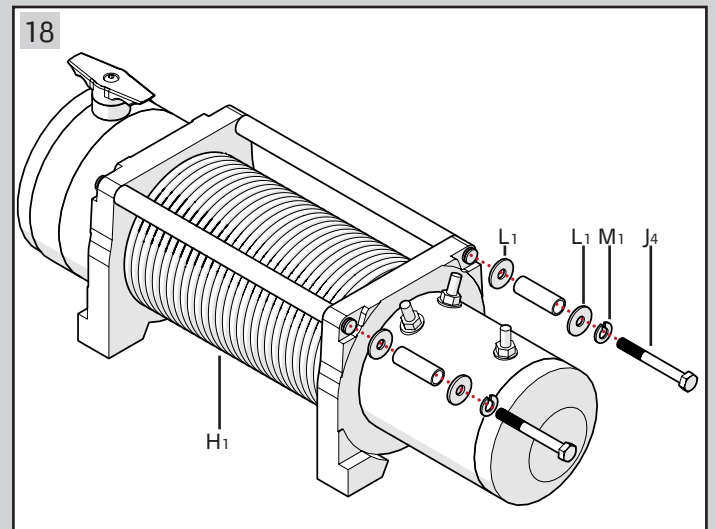
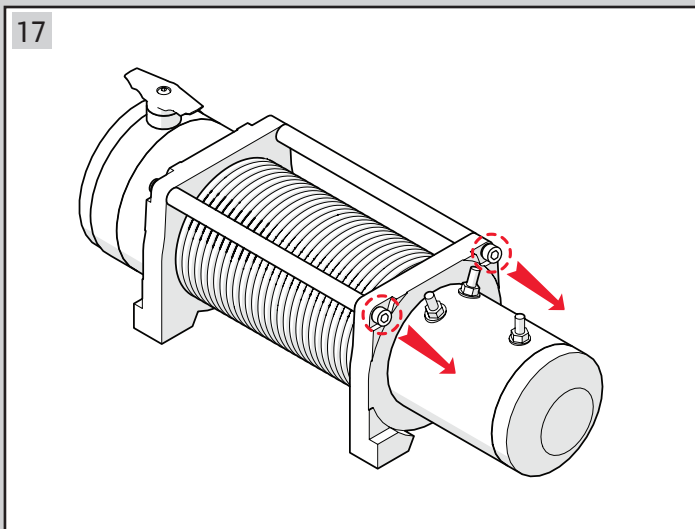
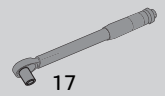
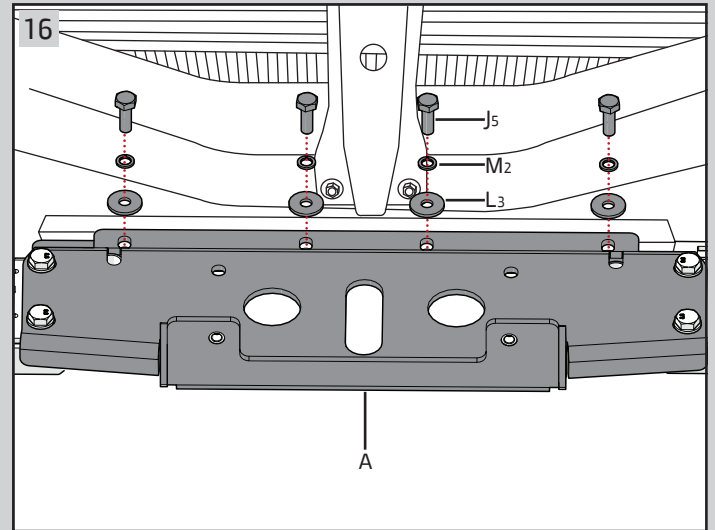

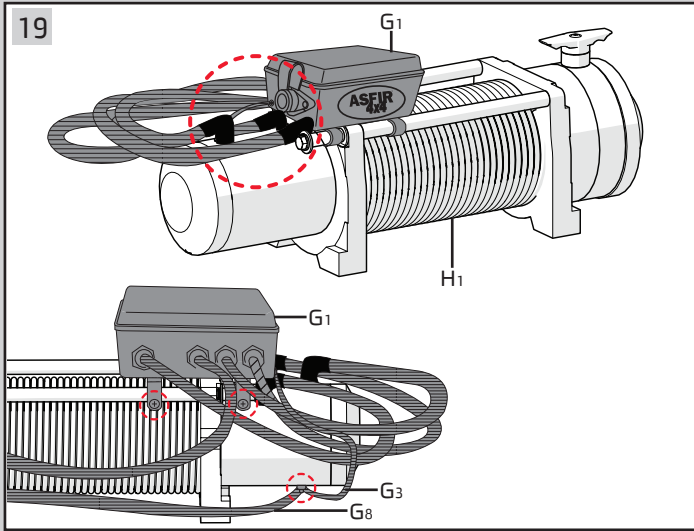

Place control box G1 on the winch as shown above

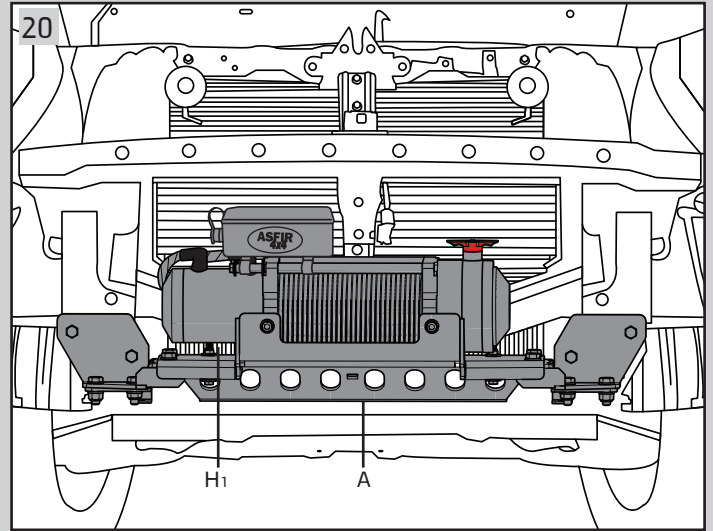

Place winch H1 on plate A

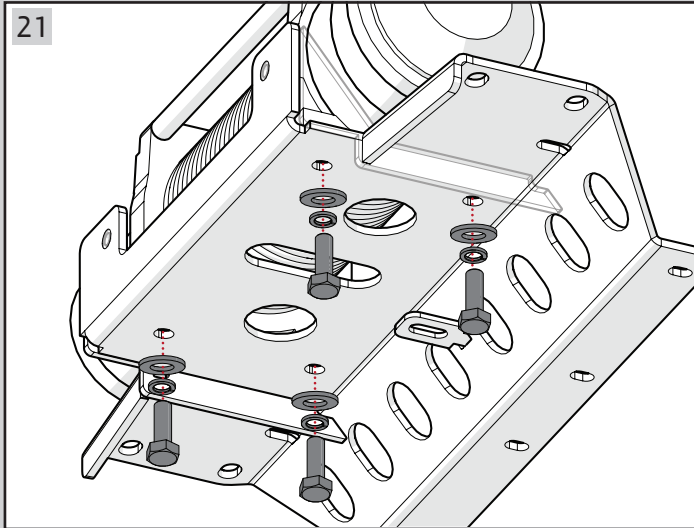

Bolts from ASFIR winch kit

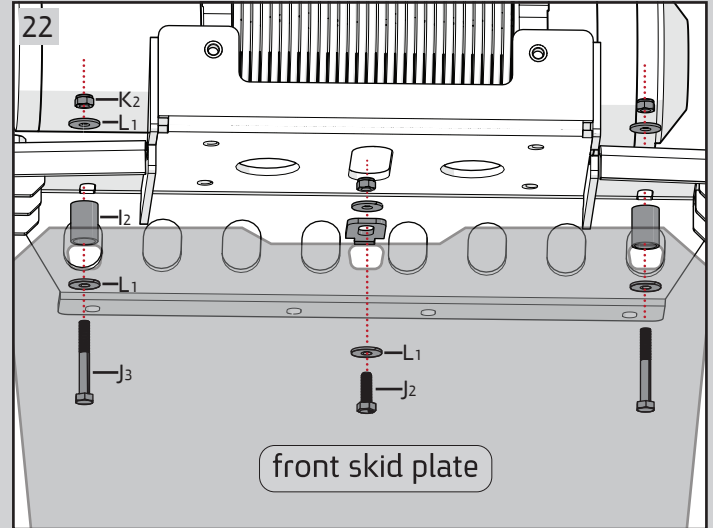
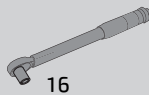

Connect ASFIR front skid plate or original front skid plate

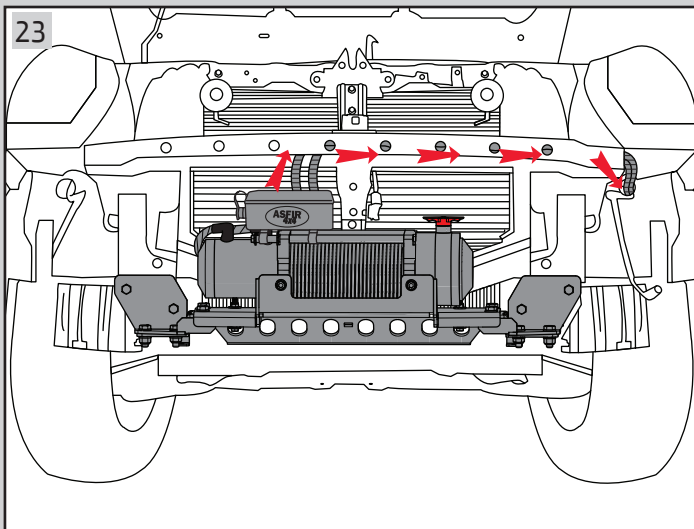
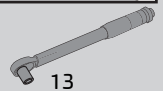

Transfer cables internally as shown above and attach with plastic handcuffs

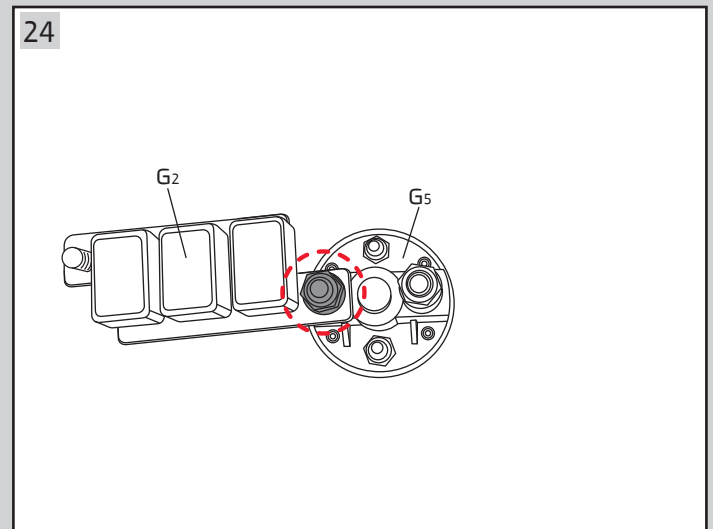

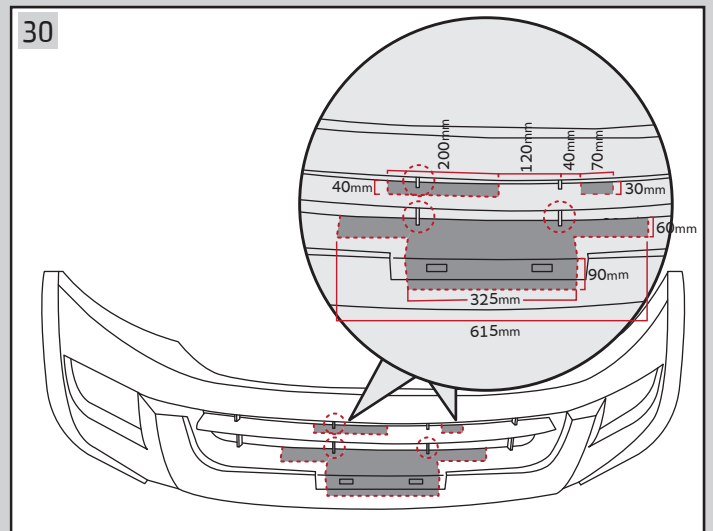
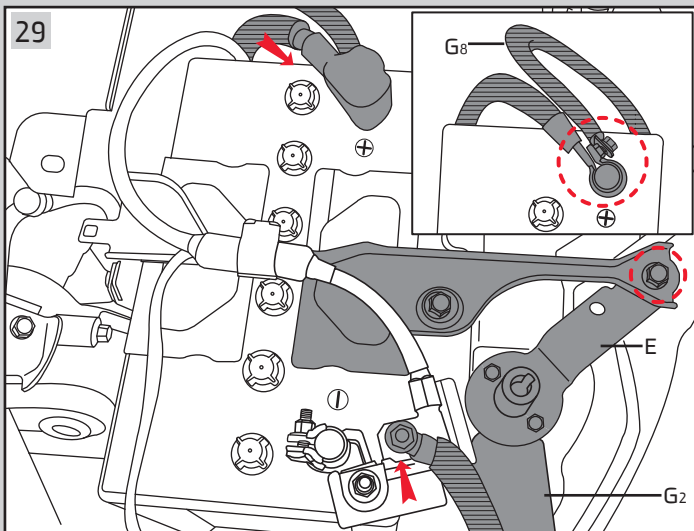
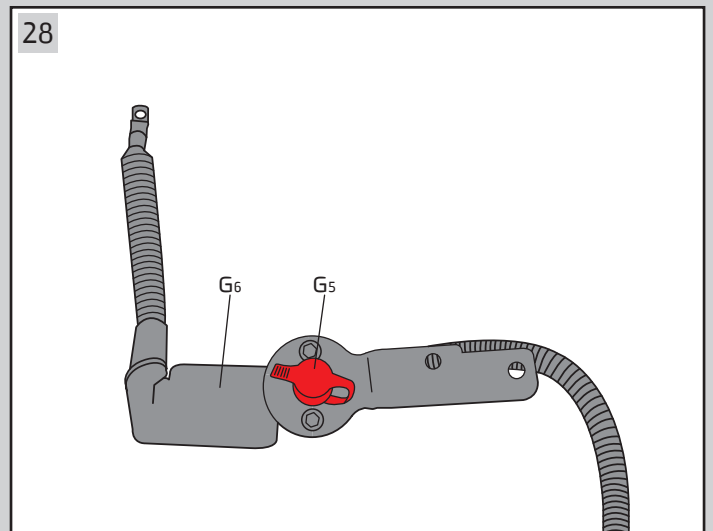
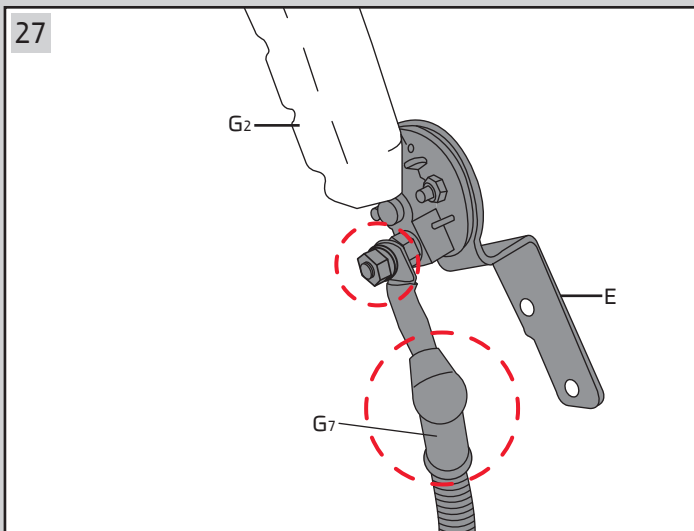
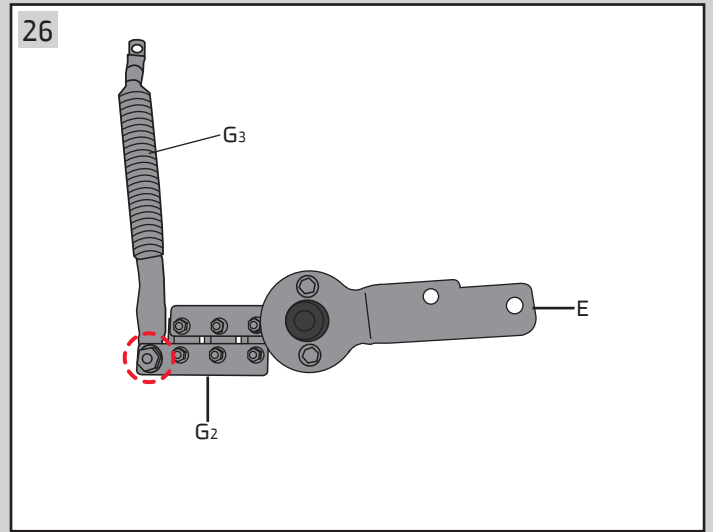
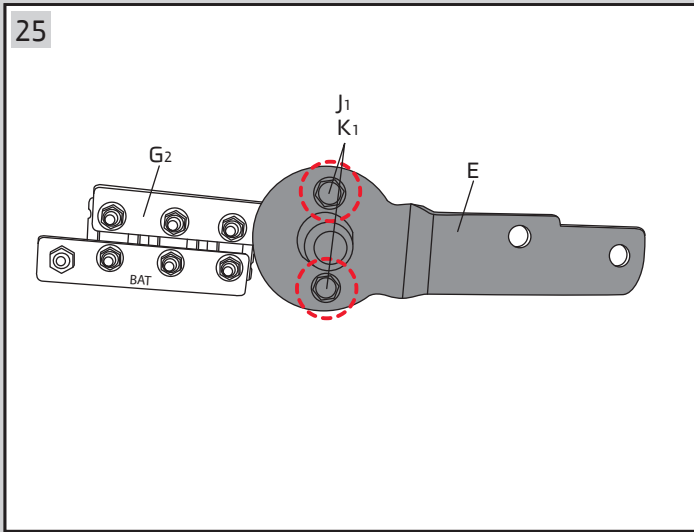

For D-Max 2012-16 - Cut out the bumper as shown on drawing. Cover the cutting line with rubber profile (N)

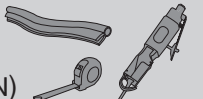

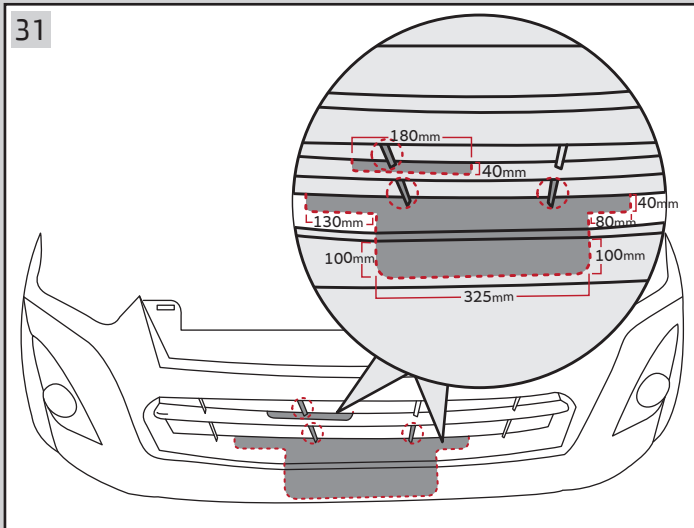

For D-Max 2017-18 -Cut out the bumper as shown on drawing.  
Cover the cutting line with rubber profile N

