

NO.	PART NUMBER	DESCRIPTION	QTY.
1	TYW66.000.001	Left Holder	1
2	TYW66.000.002	Right Holder	1
3	TYW66.000.003	Spacer	2
4	TYW66.010.000	Winch Plate	1
5	TYW25.000.007	Adapter for switch	1
6	SW25.010.003	Solenoid box bracket	1
7	4054	Neoprene 30x250	2
8	9026	Low Rubber U Shape for 3 mm L=0.95 m	1
9	1104	Hex Bolt M6x20 DIN 933	2
10	1167	Hex Bolt M6x25 8.8 DIN 933	3
11	1046	Hex Bolt M8x16 DIN 933	2
12	1168	Hex Bolt M8x25 DIN 933	1
13	1009	Hex Bolt M8x50 DIN 933	1
14	1054	Hex Bolt M10x1.5x35 DIN 933	8
15	1054	Hex Bolt M10x1.5x50 8.8 DIN 931	2
16	1049	Hex Bolt M12x1.25x30 DIN 961	2
17	1029	Socket Head Cap Screw M10x1.5x25 DIN 912	2
18	3019	Hex Nut M6 DIN 934	2
19	3006	Hex Nut Nylock M6 DIN 985	4
20	3005	Hex Nut Nylock M8 DIN 985	1
21	3022	Hex Nut Nylock M10x1.25 DIN	4
22	3037	Hex Nut Nylock M10x1.5 DIN 985	8
23	6009	Spring washer 6 DIN 127	1
24	6001	Spring washer 8 DIN 127	1
25	6008	Spring washer 10 DIN 127	4
26	6005	Spring washer 12 DIN 127	2
28	6011	Washer 6x18 DIN 9021	4
29	6003	Washer 8x20 DIN 125	2
30	6013	Washer 8x30 DIN 9021	1
31	6014	Washer 8x40	2
32	6023	Washer 10x20 DIN125	12
33	6010	Washer 10x30 DIN 9021	10
34	6015	Washer 10x40	2
35	6006	Washer 12x24 DIN 125	2
36	TYW66.020.000	WINCH ELECTRICAL EXTENSION CABLE (F1,F2,A) L=600 (Black)	2
37	TYW66.025.000	WINCH ELECTRICAL EXTENSION CABLE (F1,F2,A) L=600 (Red)	1
38	TYW66.000.000A	Instructions	1
39	TYW66.000.000B	Scheme of cutting of the original bumper	1
40	TYW66.000.004	Template For Toyota Vigo 2011-2012	1

Registration Licensing N:9113230266 Standards Institute from date 30.06.2011

Maximum Tightening Torques	
M12 (8.8)	89 Nm
M10 (8.8)	48 Nm
M8 (8.8)	24 Nm

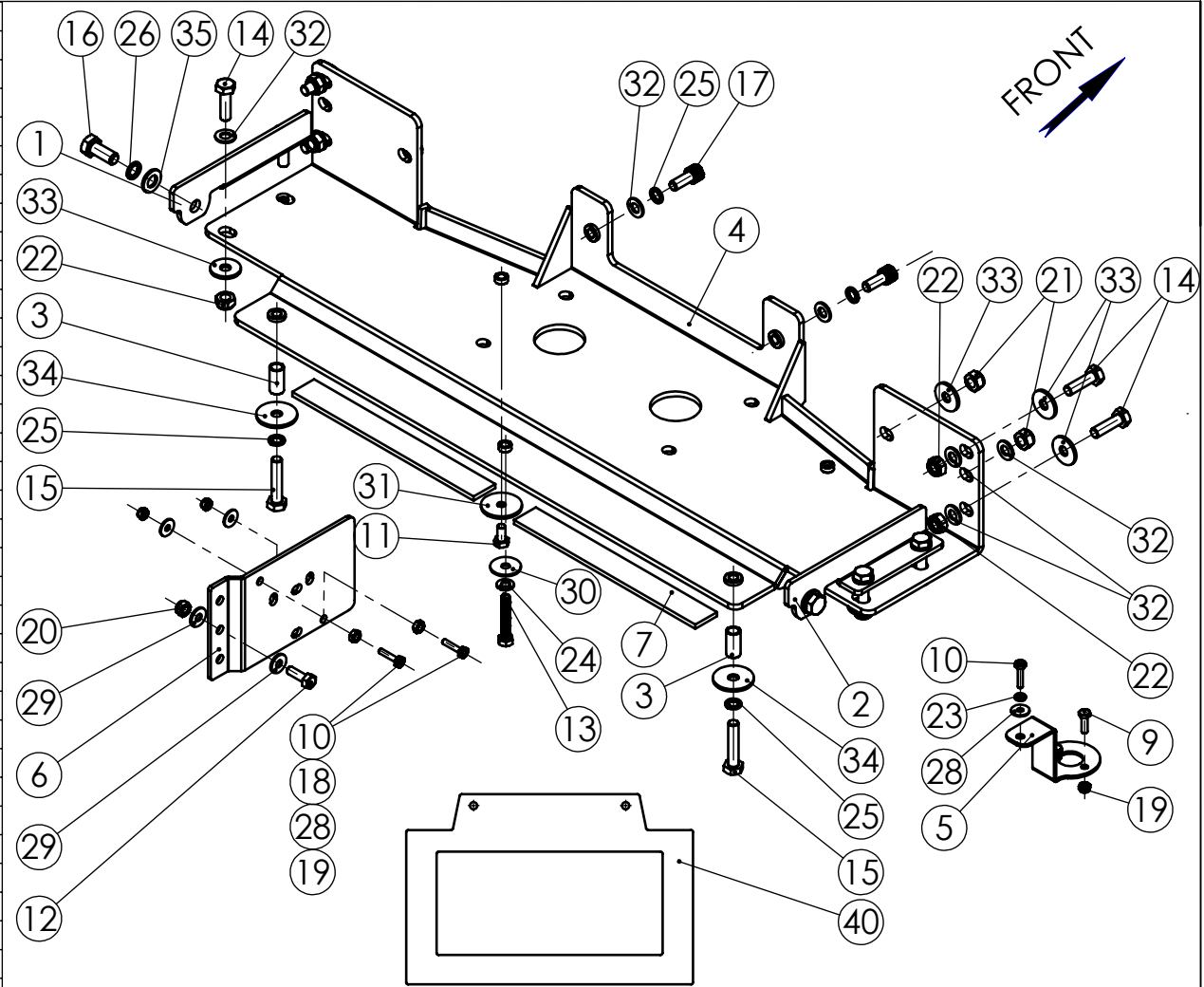

Slava CNG: Put on BOM item 39

	NAME	SIGN.	DATE
CHG.	Charnay		02.02.15
DWN.	Charnay		11.04.11
PLN.	David		
CONFIRM	Dani		

ASFIR LTD.

Drawing number		Product Description	
TYW66.000.000		Vehicle Manuf.	TOYOTA
Drawing description		Vehicle Model	HILUX VIGO
Hidden winch plate		Vehicle Version	DOUBLE CAB
Catalogue number		VIN	MR0FR22G800583747
533024		Year of Product.	2011 - 2014
Weight,kg 16		Gear Shift	AUTOMATIC/MANUAL
Sheet 1		Motor Model	DIESEL
Sheets 2		Transmission	4x4

NO.	PART NUMBER	DESCRIPTION	QTY.
41	10283	Corrugated Pipe ϕ 17m"m L=4000m"m	1
42	9522	Electric Cable 5 Wires ϕ 1.5m"m L=500m"m	1
43	101006	Butt Crimp Red Color	6
44	1287	Phillips head tapping screw 4.8x30	4

Hudden winch plate are used with SuperWinch AS9500
 Catalogue number 722001

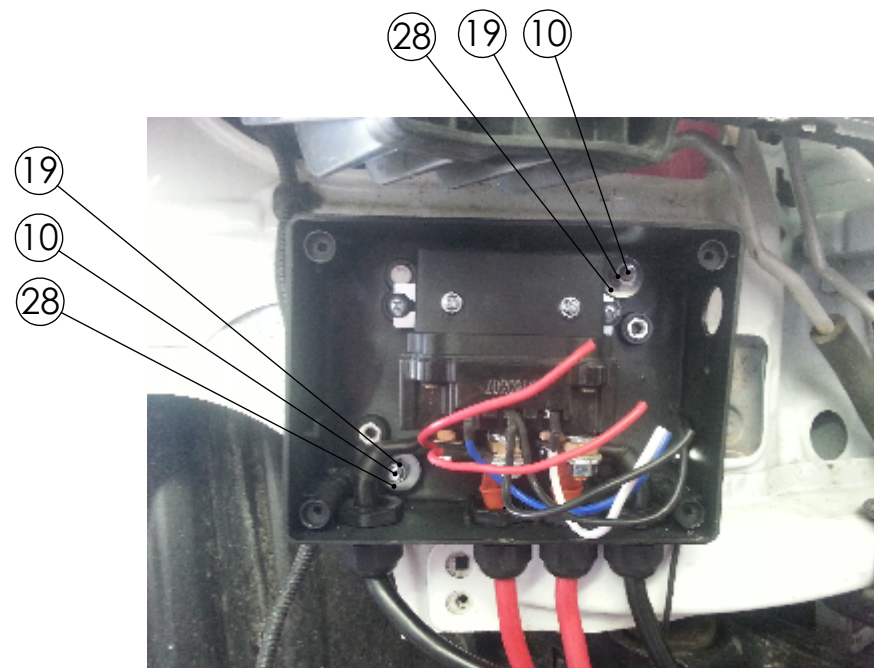

ASFIR LTD.	Drawing number	Drawing description
	TYW66.000.000	Hidden winch plate
	Sheet 2	Vehicle Toyota Hilux Vigo
		Sheets 2