

Urea Tank skid Plate Mounting instructions for Toyota Hilux 2016-18

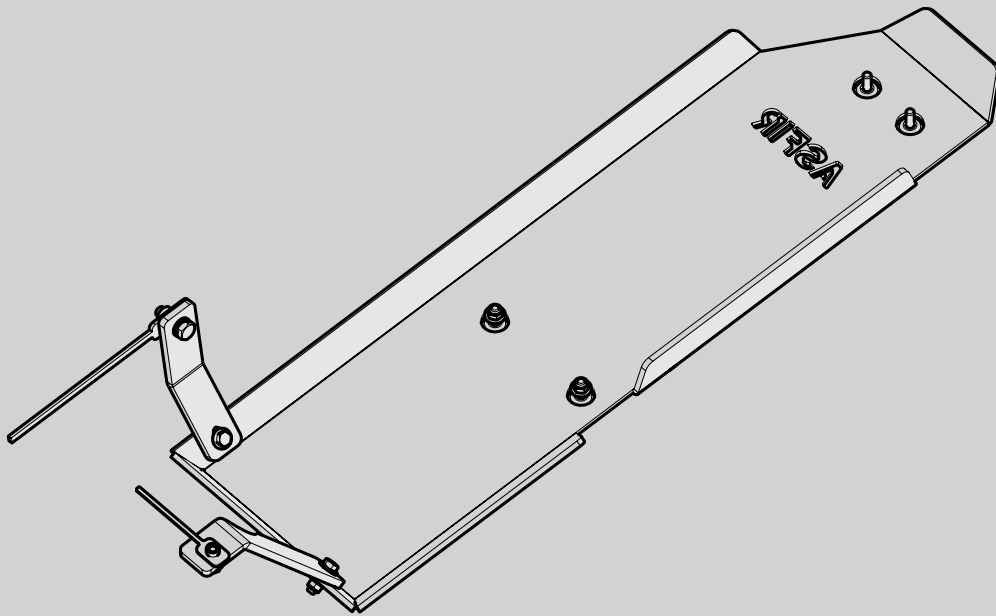

**NOTE: HAS TO BE MOUNTED TOGETHER WITH
TRANSFER/GEAR SKID PLATE P/N 533261**

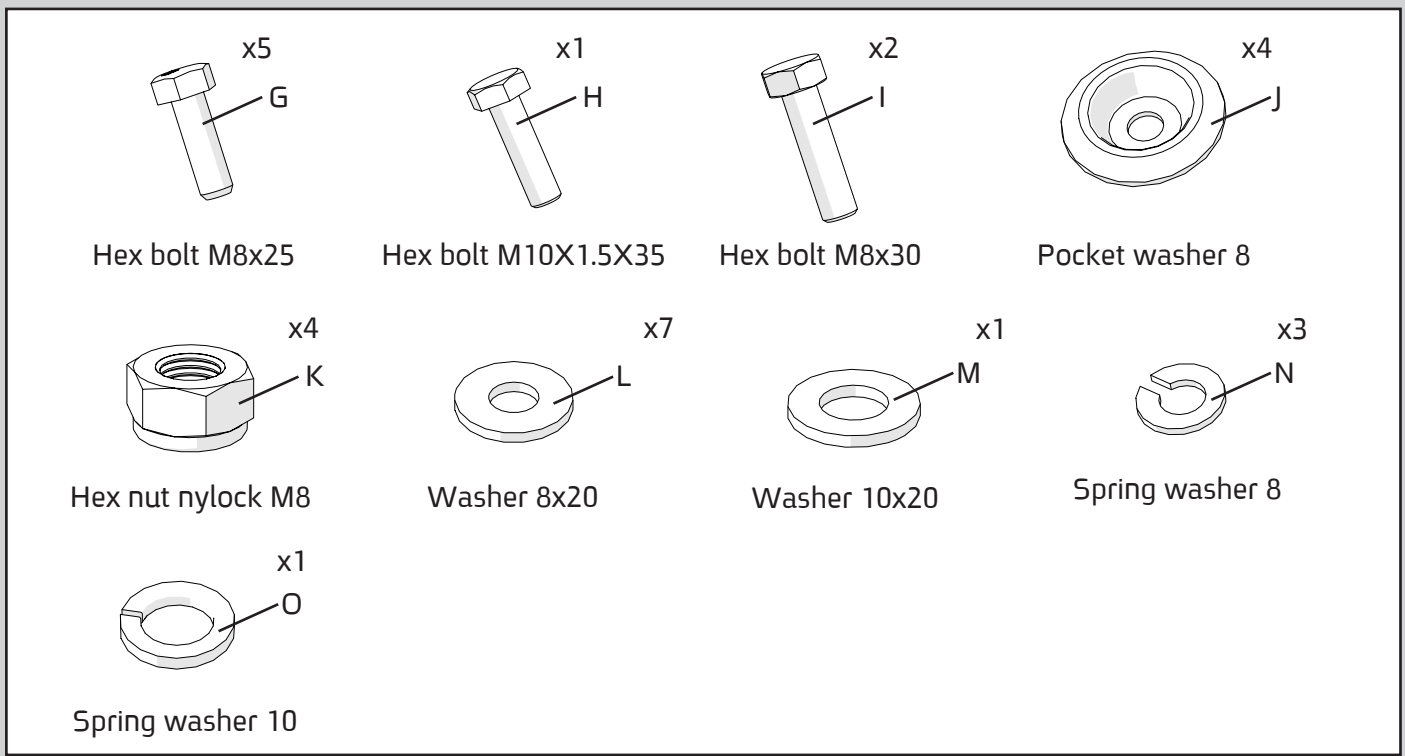
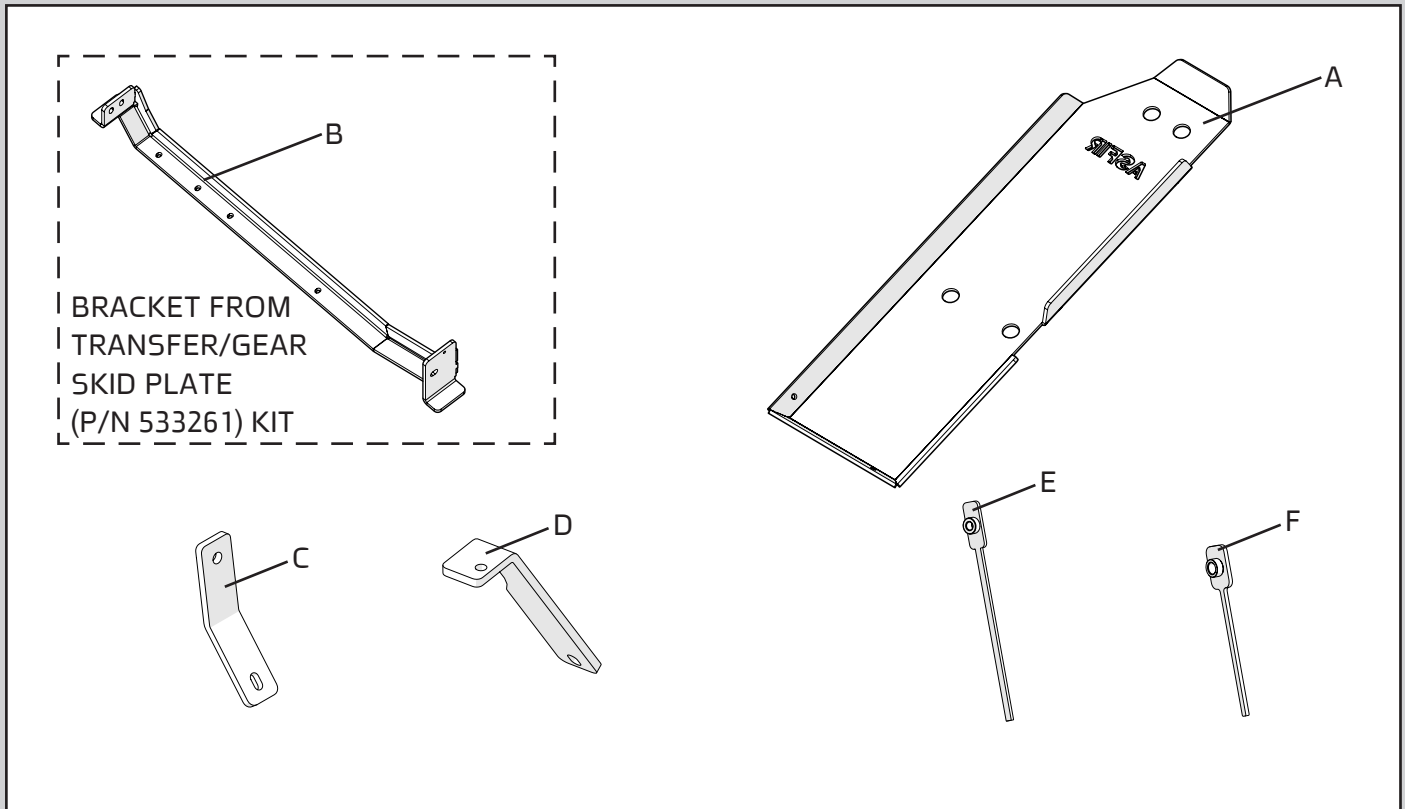

Maximum Tightening Torques	
M8 (8.8)	25 Nm
M10(8.8)	50 Nm
M12 (8.8)	85 Nm

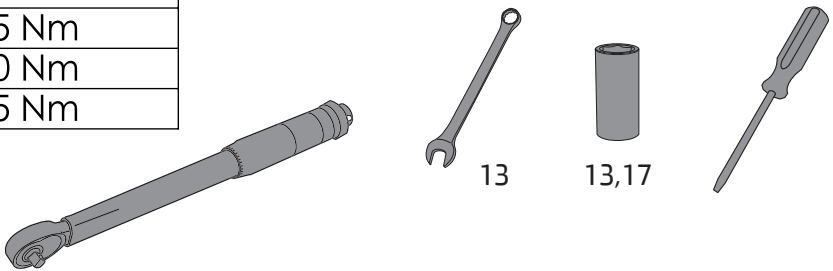

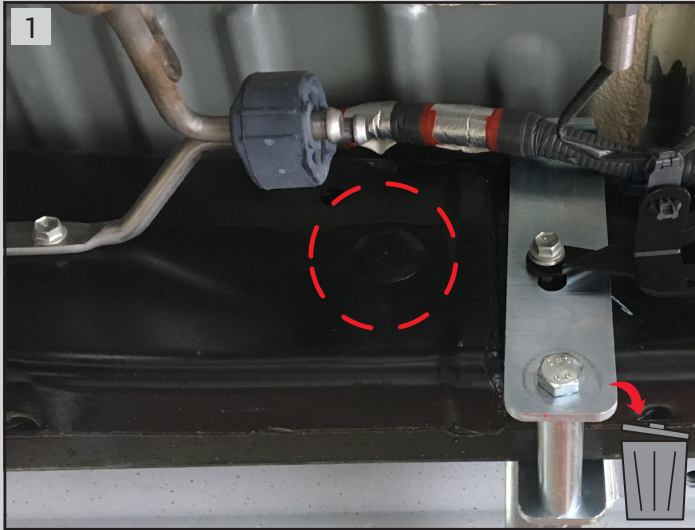

1 Remove the cap from chassis inner side on vehicle right side

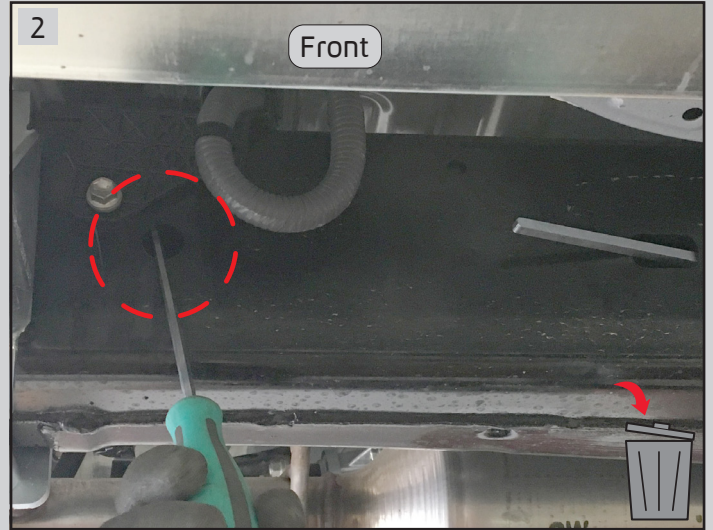

2 Remove the cap from chassis outer side on vehicle right side



3 Place bracket (B) and connect it using bolt (H), spring washer (M) and washer (K) to the chassis. Right bolt - dont tighten it yet, leave for after placing the skid plate

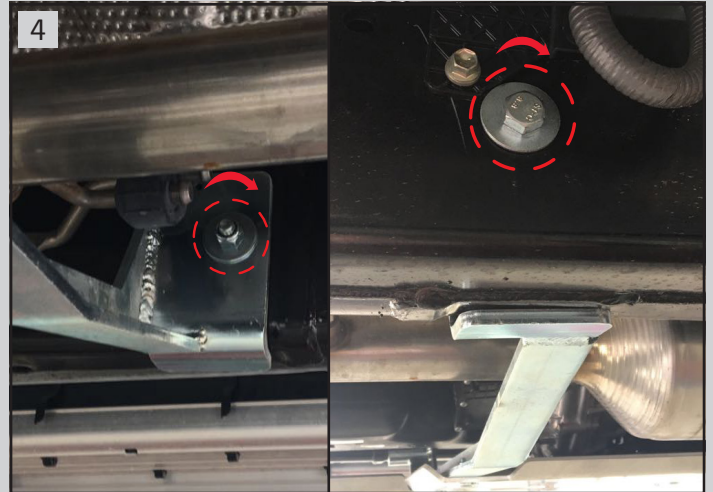

4 Insert spacer (D) through chassis and tighten bolt (E) and washer (L) into the chassis outer side. Connect bracket (B) to chassis using hex nut (J) with washer (L) to spacer (D)

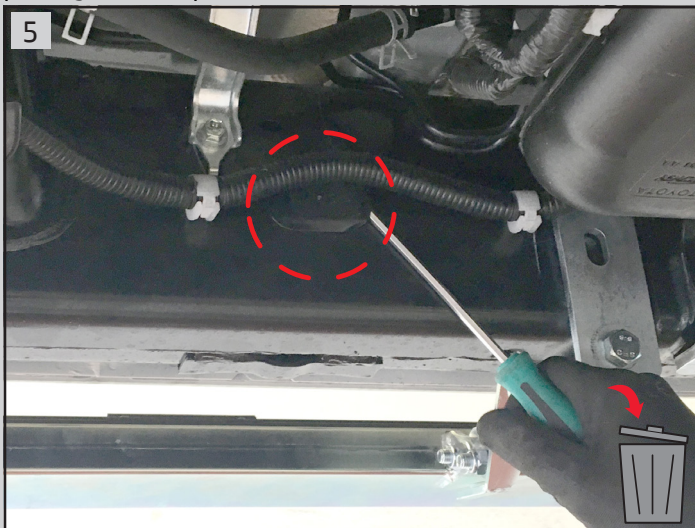

5 Remove the cap from chassis inner side on vehicle left side



6 Remove the cap from chassis outer side on vehicle left side



7
Bend plate (E)



8
Insert plate (E) through the hole and into the chassis

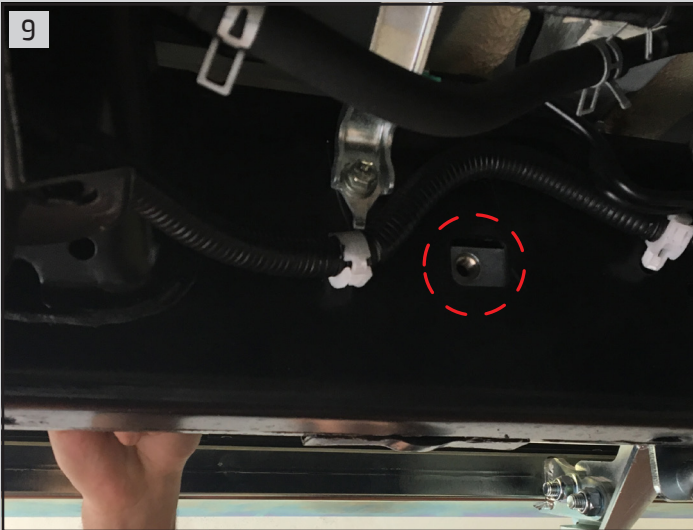

9
Align plate (E) to the hole

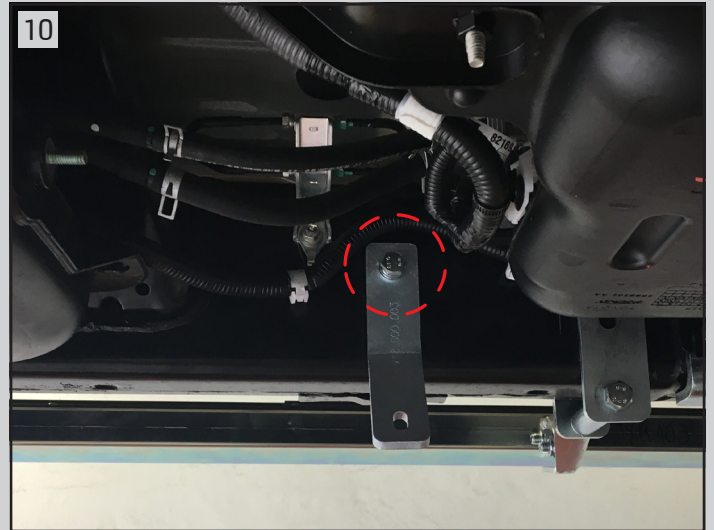

10
Connect bracket (C) to chassis using bolt (H),
spring washer (O) and washer (M)



11
Insert plate (F) into the chassis



12
Align plate (F) to the hole

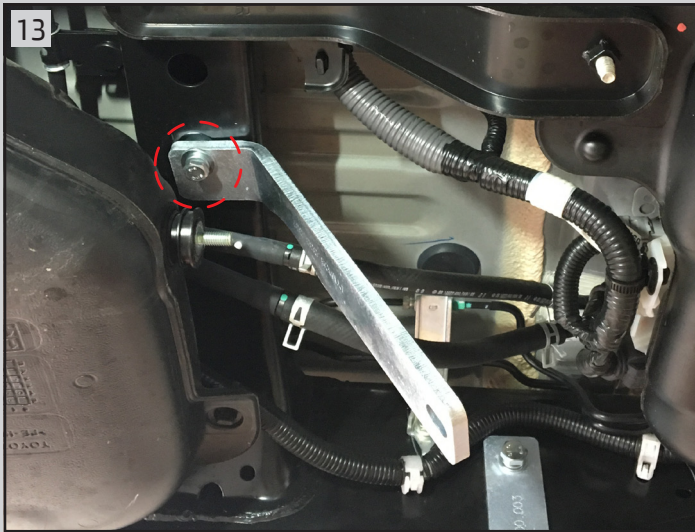

Connect bracket (D) to chassis using bolt (G), spring washer (N), washer (L) into plate (F)

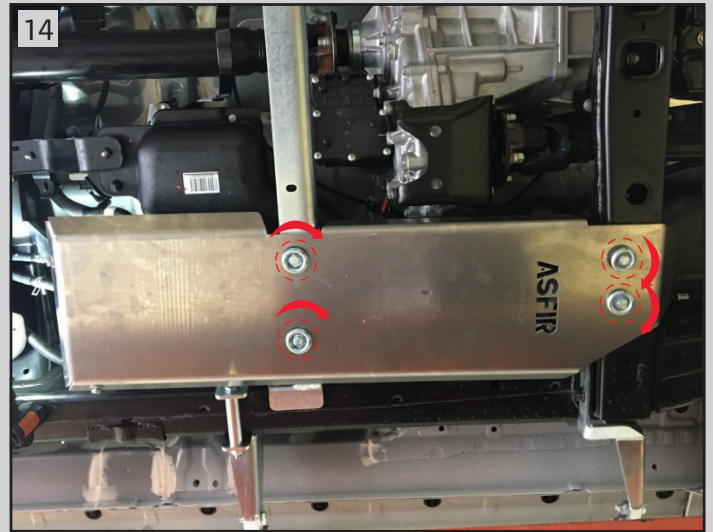

Connect plate (A) to bracket (B) using 2 hex bolts (G), pocket washer (J), washer (L) and hex nut (K).
Connect plate (A) to the chassis using 2 hex bolts (G), spring washer (N) and pocket washer (J) into the original screwing

13



Connect plate (A) to bracket (C) using bolt (I), washer (L- on both sides of the plate) and hex nut (K)

13



Connect plate (A) to bracket (D) using bolt (I), washer (L- on both sides of the plate) and hex nut (K)

13