

Front skid plate

Mounting instructions for Toyota Land Cruiser 150/155 2018

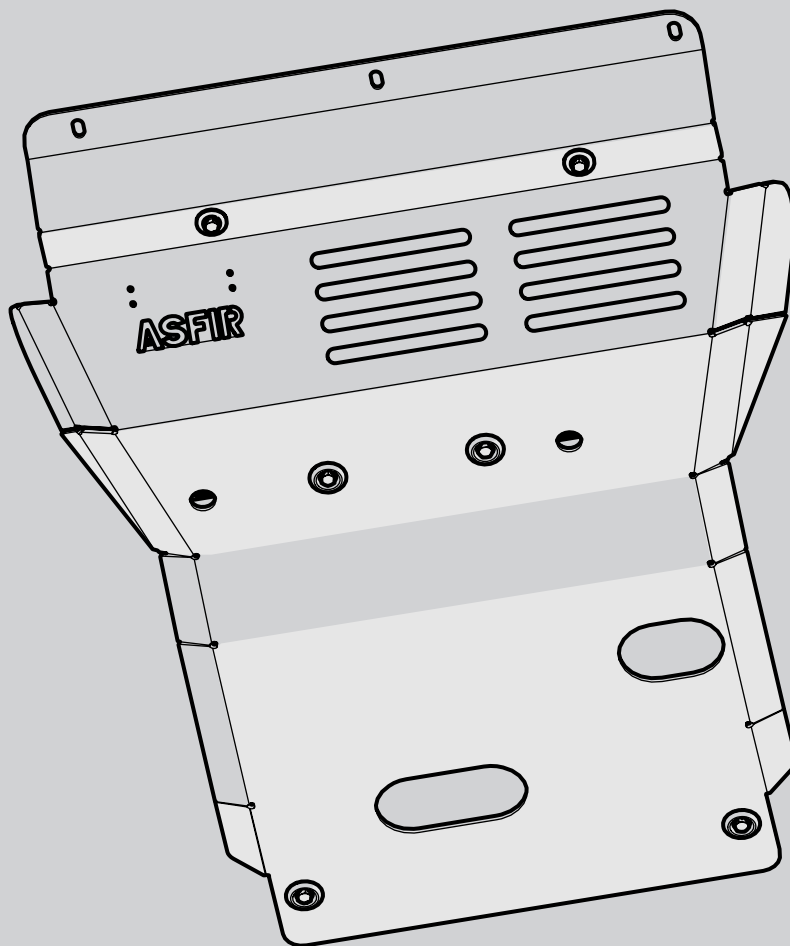

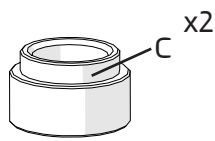
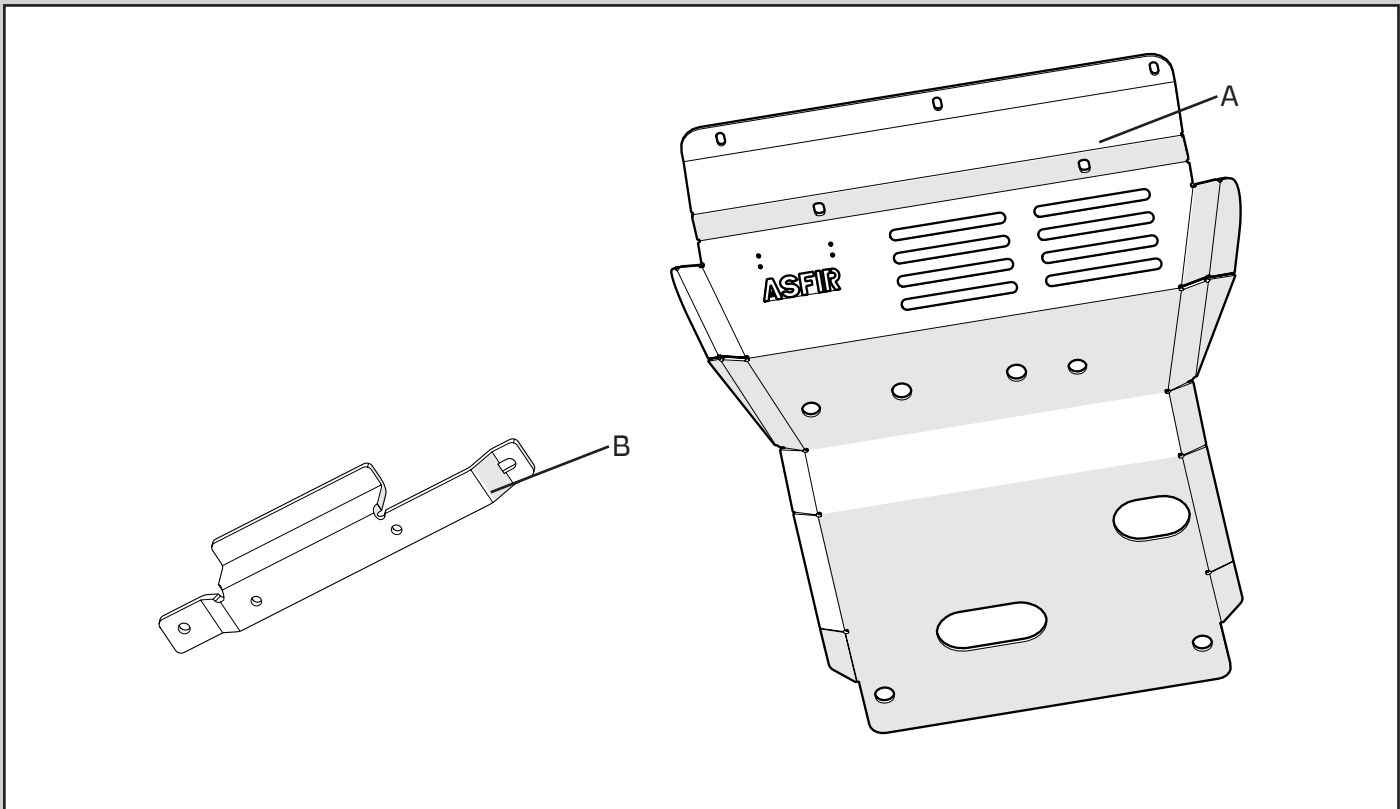

Spacer 1/2" L-13

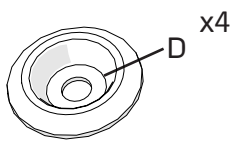

Pocket washer 8

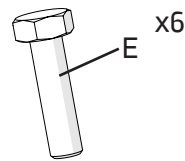

Hex bolt M8x30

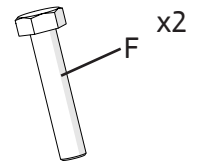

Hex bolt M8x40

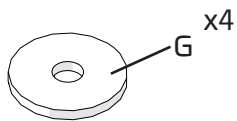

washer 8x30

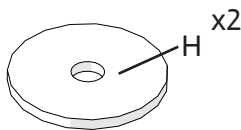

washer 8x40

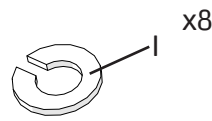

Spring washer 8

Maximum Tightening Torques

M8(8.8)	25 Nm
---------	-------

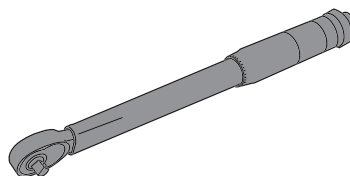

12,13

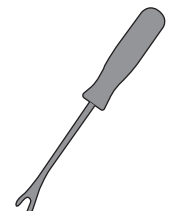

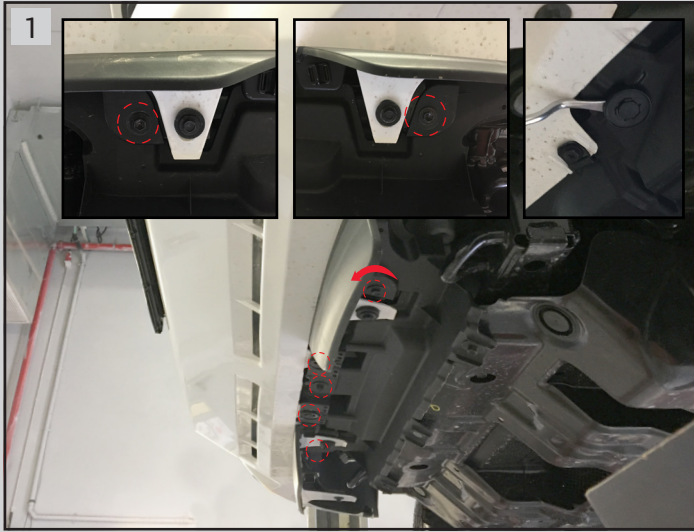

1 Remove the 3 bolts and 2 clips

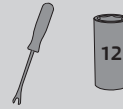

2 Remove 4 bolts and middle clips.
Dispose the original plate

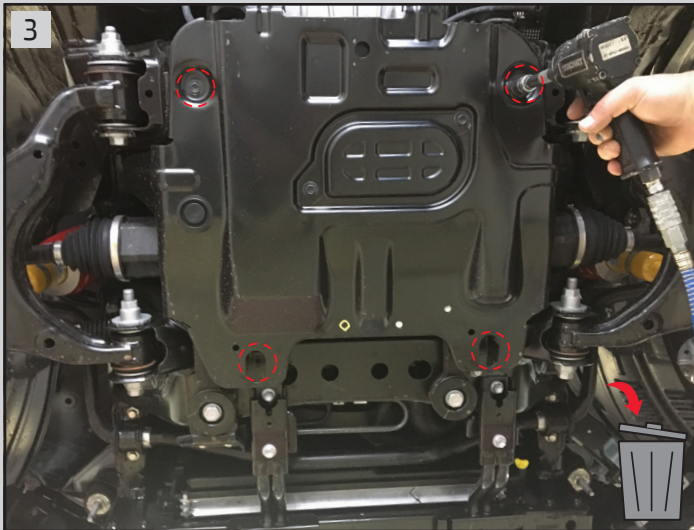

3 Remove 4 bolts and dispose the original plate



4 Connect the bracket to the original screwing using
hex bolt (E), spring washer (I), and washer (G)

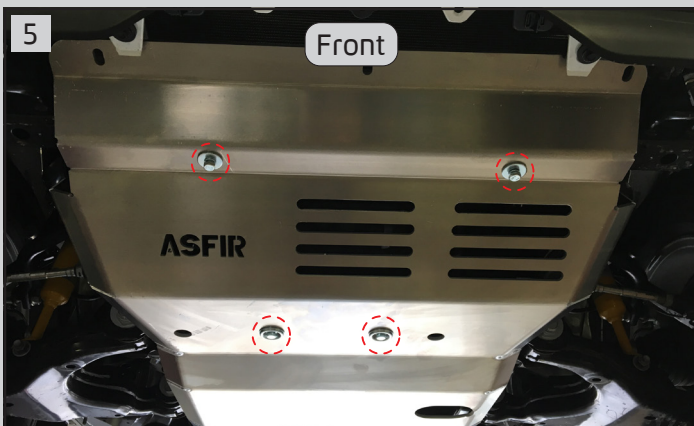

5 In the front, connect plate (A) to original screwing
using hex bolt (E), spring washer (I) and washer (G).

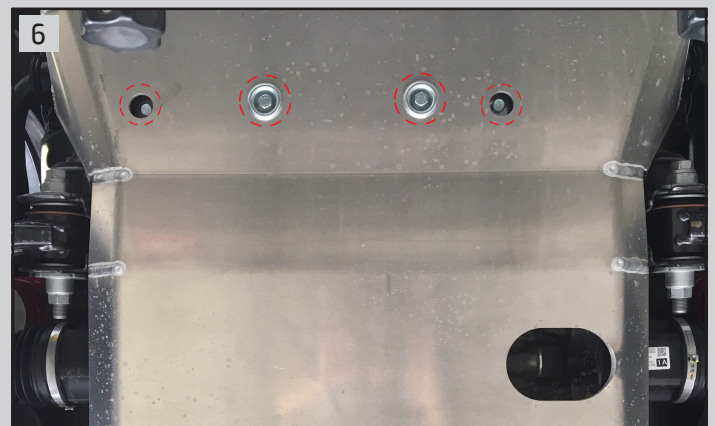

6 In the middle connect bracket (B) to the plate (A)
using hex bolt (E), spring washer (I), and washer (D)



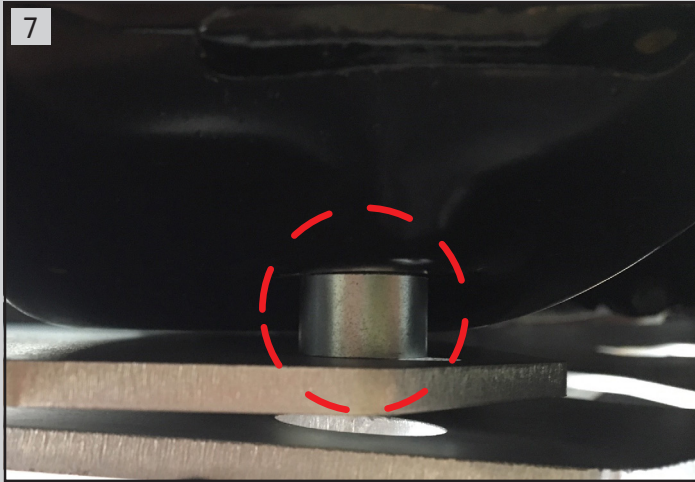

In the rear place spacer (C) and align it with the front holes of plate (A)

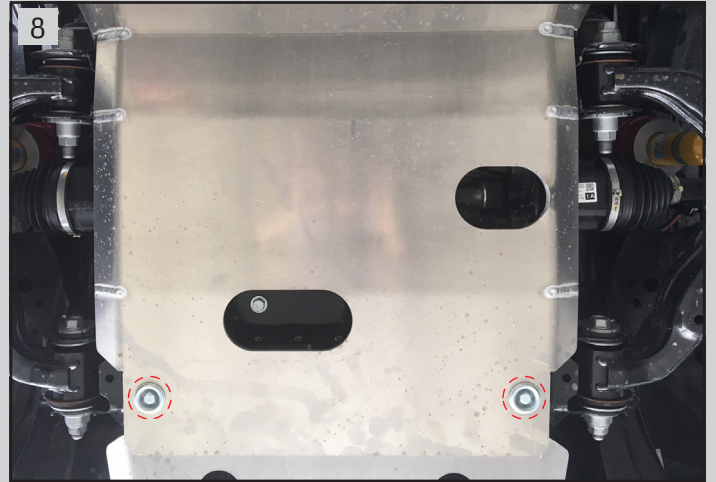

Connect the plate to original screwing using hex bolt (F), spring washer (I), pocket washer (D).
Tighten all 6 bolts of the skid plate