

Confidential

All rights in and to this document are property of ASFIR Ltd. and reserved to it. This document is forwarded to the recipient under the condition of and subject to the obligation of the recipient to keep the confidentiality of its contents. Copying, transfer or distribution of this document or its contents and the use of it not for the purpose intended are strictly forbidden.

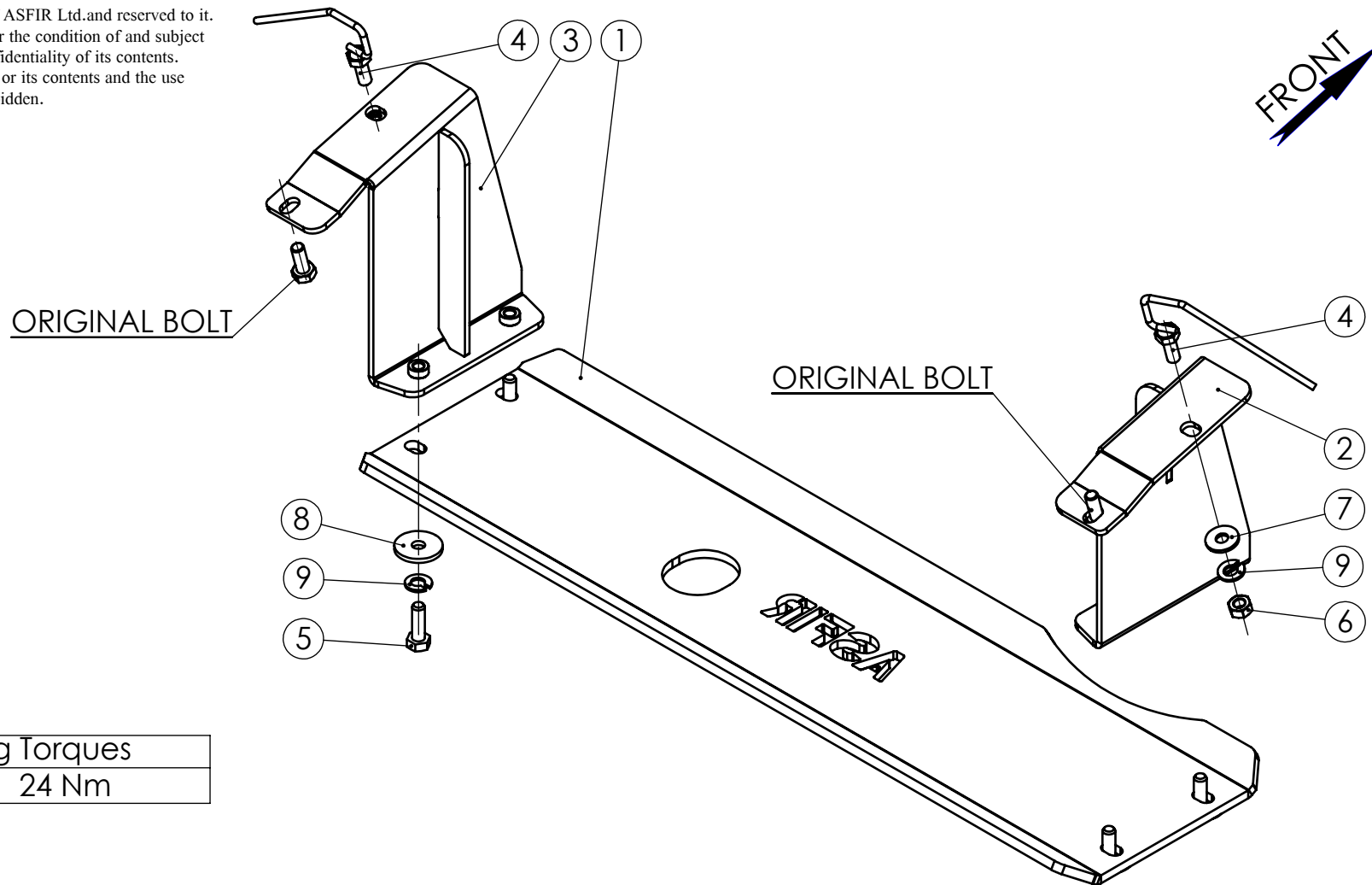

Maximum Tightening Torques

M8 (8.8)	24 Nm
----------	-------

NO.	PART NUMBER	DESCRIPTION	QTY.	CHG.	NAME	SIGN.	DATE	Drawing number	Product Description		
1	TYM86.000.001	Skid plate	1	CHG.	CHARNAY		14.08.12	TYM86.000.000	Vehicle Manuf.	TOYOTA	
2	TYM86.010.000	Right bracket	1	DWN.	CHARNAY		13.05.12		Vehicle Model	LAND CRUISER 80	
3	TYM86.010.000L	Left bracket	1	PLN.	DAVID		14.08.12	Drawing description	Vehicle Version	LWB	
4	TYM86.000.002	Spacer bolt M8x20	2	CONFIRM	Dani			Engine Skid plate	VIN	JT3DJ81W4S0094519	
5	1168	Hex Bolt M8x25 DIN 933	4	<b>ASFIR LTD.</b>				Catalogue number	Year of Product.	1991-1997	
6	3002	Hex Nut M8 DIN 934	2					Weight,kg	4.0	Gear Shift	MANUAL / AUTOMATIC
7	6003	Washer 8x21 DIN 125	2					Motor Model	PETROL/DIESEL	Transmission	4X4
8	6013	Washer 8x30 DIN 9021	4								
9	6001	Spring washer 8 DIN 127	6								